

Load Beam Series

250kg to 10,000kg

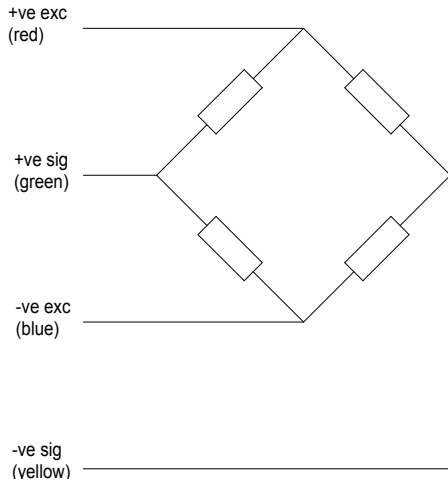

- Welded covers
- Stainless steel
- Sealed to IP68
- ATEX certification available
- Integral mounting base
- High accuracy
- Two year warranty



Capacities	250,500,1000, 2000,5000, 10000	kg
Full Load Output	2.0 (±0.25%)	mV/V
Zero Load Output	<±2.0	%
Excitation (Max)	10 (15)	V
Accuracy	<0.03	%
Repeatability	<0.01	%
Input Resistance	410 (±30)	Ω
Output Resistance	350 (±2)	Ω
Compensated Temp. Range	-10 to +40	°C
Operating Temp. Range	-20 to +70	°C
Temp. Coefficient on Zero	<0.0015	% Capacity/°C
Temp Coefficient on Span	<0.002	% Capacity/°C
Safe Overload	150	%
Insulation	>500 @100Vdc	MΩ
Environmental Protection	IP68	

Specifications subject to change without notice

Capacity (kg)	A	B	C	D	E	F	G	H	ØJ	W1	W2	ØI
250 – 1000	135	25.4	76.2	38.1	26	16	58.5	28	13	22	27	M12x1.75
2000	135	25.4	76.2	38.1	26	16	58.5	28	13	22	27	M16x2.0
5000	170	38.1	95.3	50.8	36	20	76	39	21	28.5	36	Ø21
10000	220	50.8	120.7	68	46	26	105	52	26	35.5	50	Ø26

All dimensions in mm

Options :
Vessel mounting kit, load button and instrumentation.
Please enquire for details.
Atex version available.

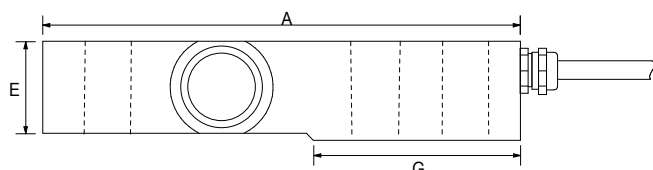
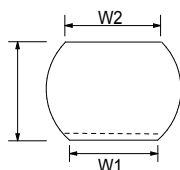
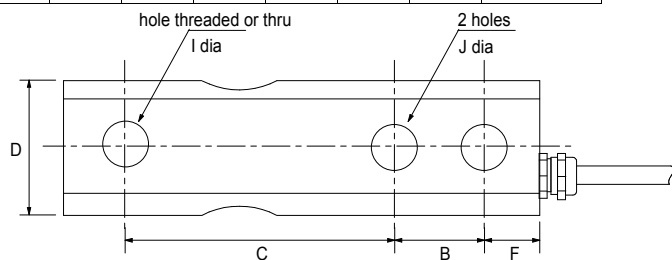

Lorijn & Loos Multi Function BV
W.M.Dudokweg 40 1703 DB Heerhugowaard
+31 72 5745254 / +31 72 5745285 Fax

SELB
ATEX / IECEx Approved to
Ex ia IIC T6
Ex tD A20 IP68 T85C

